



POWER KEY Series P055-155BX

**New External
Adjustment!**

SYSTEM

Powerful 55-watt compact fluorescent unit with adjustable beam spread. An external slide knob at the back of the fixture allows a free range of adjustment from 60° to a 90° beam spread. Provides a concentrated, even coverage for studio or location lighting applications without added accessories. Additional control achieved with zone screen accessory option. All 230 volt fixtures are RoHS compliant.

UL/CUL/CE Damp Location Listed.

U.S. Patent #6,945,671

SPECIFICATION

Housing: Constructed of .063 formed aluminum, then coated with black textured TGIC polyester coat finish.

Reflector: Formed .020 high purity aluminum (99.9%) reflector material with 95% reflectance finish.

Socket: Molded white high strength thermoplastic with push wire connections and 18-gauge leads. Model number 2G11 4-pin. Mounted to adjustable bracket to alter beam spread.

Electrical: Unit contains (1) 1-lamp ballast to drive a 55-watt lamp for a total of 55 lamp watts per fixture. Power factor shall be >.97 with a class A sound rating and THD of <20%. Power entry on unit includes on/off switch, fuse holder with fuse (for protection against power surges), spare fuse and IEC connector.

Mounting: Provided with .125 welded aluminum yoke which allows vertical or horizontal mounting. Unit may rotate vertically through the yoke and horizontally through a pipe clamp for ease of focus, and may be locked into place.

Fixture Includes:

- (1) 55-watt Biax Lamp
- (1) 1-lamp Ballast (Specify Voltage)
- 16' power cord with NEMA5-15 (3) prong plug
- (1) C-Clamp or 5/8" Stand Adapter (Specify One)

LAMPS (Included)

55-watt FT55W/2G11/830

3000K, 12,000 Hours Lamp Life

CRI: 82

Light output: 4800 LM/Lamp

OPTIONS (Must Specify Each)

Ballast	120 VAC/60Hz HPF Electronic
	230 VAC/50-60Hz HPF Electronic
Mounting	2" O.D.C-Clamp
	5/8" Stand Adapter
Lamps	3000K (Included as Standard)
	3200K (Additional charge)
	5500K (Additional charge)

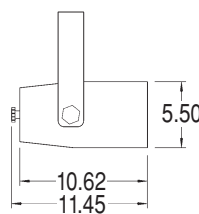

Side View

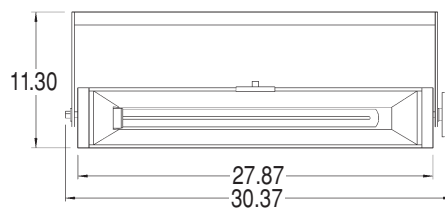

Face View

Measurements shown are inches (B.S.U.) Ref: 1"=2.54cm.

MODEL

P055-155BX-ND	Non Dim
P055-155BX-OB	On Board Dim
P055-155BX-DMX	DMX control within fixture.
P055-155BX-D/PM*	Phase Control

* Not available in 230 Volt

WEIGHT	Lbs	Kg	DIMENSIONS	Inches	Cm
Complete	12.0	5.5	Length	30.37	77.1
DMX	0.5	0.2	Height	11.3	28.7
			Width	11.45	29.1

ACCESSORIES

(See detailed description and function in Accessories Section)

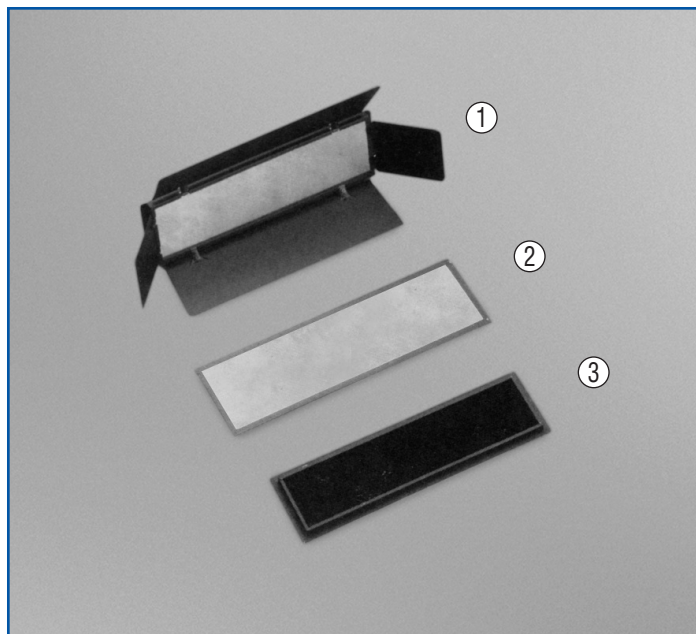

PART

- | | | |
|---|-----------|--------------------------|
| ① | BD-P055 | Barn Door |
| ② | GF-P055 | Gel Frame |
| ③ | ZS-P055-W | Zone Control Screen Wide |

EXTERNAL LAMP ADJUSTMENT



*New Easy
Slide Knob to
Adjust & Lock
the Light Beam.*

PHOTOMETRICS

4-06		DISTANCE			
MODEL P055-055BX		3ft/.91m	6ft/1.83m	9ft/2.74m	12ft/3.66m
NO ACCESSORIES	FC	332	83	37	21
	Lux	3574	893	398	226

Light level readings were measured in foot-candles (fc) and converted to Lux using the conversion factor of 1 fc = 10.765 Lux. Values shown are light levels on centerline. Reference: Meter used—Minolta T-1 Illuminance meter. Lamps: 3000 Kelvin. Ambient temperature in test studio 75F ±3F. Distance measurements converted to meters using 1ft = .305m. Original photometric data on file at the factory. Specifications subject to change without notice or obligation.